

AQUAPHOR[®]

water filters

PRESSURE BOOSTING UNIT (100 GPD)

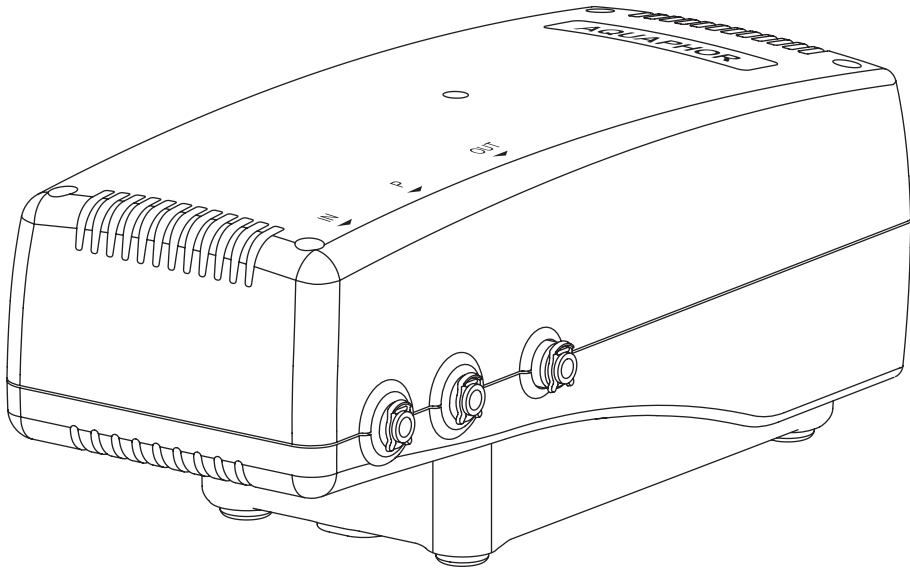

OPERATION MANUAL

Suitable for all Aquaphor reverse osmosis systems.

DELIVERY SET

1. Pressure boosting unit assembled 1 pc.
2. Set of tubes and fittings:
 - 2.1. Tube 1/4 " (1.2 meters), blue colour 1 pc.
 - 2.2. Pressure reducer with tube 1 pc.
 - 2.3. Three-way valve with tube 1 pc.
 - 2.4. Restrictor 50 gallon 1 pc.
3. Power supply unit* 1 pc.

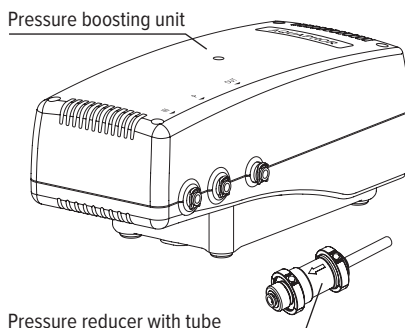

PRINCIPAL OF OPERATION

Pressure boosting unit is designed to increase the water pressure and filtration rate in the water purifier. It operates from the main power supply connecting by a power supply unit. Pressure boosting unit automatically turns off

- when the storage tank (or jug) is full
- when the main water supply is disconnected.

Pressure reducer with tube is required to be installed and is designed for safe operation of the water purifier in the event of a sharp pressure increase in the main water supply.

TECHNICAL CHARACTERISTICS

Size (length × width × height)	230 × 121 × 76 mm
Minimum pressure in the water supply network	0.05 MPa (0.5 at)
Maximum pressure in the water supply network, no more than	0.63 MPa (6.5 at)
Water temperature	from +5 to +38 °C
Pressure boosting unit power supply	24 V ± 5%, at least 1.5 A DC
Weight, not more than	1.7 kg

* Main characteristics of the power supply unit

Input voltage	100–240 V AC
Input plug mounted in the CEE	7/16 unit
Output voltage	24 V DC
Output current	1.5 A
The output connector is coaxial,	Ø 2.5 × Ø 5.5 mm
Wire length, not less than	1.0 m

Electrical Power Supply

Before connecting the Pressure boosting unit to the power supply, check that the power supply voltage corresponds to the parameters specified in the Pressure boosting unit Manual. Use only a power supply with the output characteristics specified in this manual (24 V ± 5%, at least 1.5 A DC). Before installing the Pressure boosting unit, make sure that it will be protected from freezing, water ingress, direct sunlight, contact with hot objects, including hot water pipes, radiators, and heating devices. Protect from shocks and fallings. The cord of the power supply connected to the Pressure boosting unit must not be stretched. Make sure that the power cord does not touch surfaces that can damage it.

Do not immerse the Pressure boosting unit, its power supply, the power cord and the plug in water or other liquid. Do not wash them under running water or in the dishwasher.

To avoid electric shock, do not touch the Pressure boosting unit connected to the power supply, the power supply unit, its power cord and plug with wet hands.

Do not allow contamination of the Pressure boosting unit housing. If necessary, wipe it with a dry cloth, after disconnecting the Pressure boosting unit from the power supply.

Do not disassemble the Pressure boosting unit or open its housing!

Do not use the Pressure boosting unit and the power supply if problems or damage to the wire are detected. Do not attempt to repair the device yourself. If any malfunction is detected, first disconnect the power supply from the mains, then disconnect it from the Pressure boosting unit. Contact customer service.

INSTALLATION

Attention! It is not recommended to connect the Pressure boosting unit to the water purifier yourself. To connect the Pressure boosting unit, it is recommended to contact Aquaphor customer service or Aquaphor regional dealers.

The manufacturer is not responsible for the improper quality of the work on connecting the Pressure boosting unit to the water filter, as well as for the result of this work. Responsibility for the shortcomings of this work, as well as for causing harm to the health or property of the customer or other people as a result of these shortcomings, is borne by the party performing the installation.

Select appropriate location for the Pressure boosting unit. Note that the connecting tubes should be loose and not bent. The free sections of the tubes should be fixed so that they cannot be damaged by other objects.

The water filter must be placed at a distance or isolated from any heat sources (kitchen ovens, boilers, hot water supply pipes, dishwashers or washing machines, etc.) and placed in a place that prevents water from entering the housing of the Pressure boosting unit and the power supply unit.

How to connect the tubes

Remove the stopping clip from under the plastic sleeve, insert the pre-wetted end of the tube into the sleeve of the fitting until it stops at a depth of about 15 mm and insert the clip. Check the strength of the fastening of the tube: at a force of 8-10 kgf, the tube should not be pulled out.

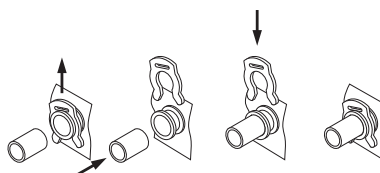

How to disconnect the tubes

To disconnect the tube, pull out the stopping clip from under the plastic sleeve and, pressing the end of the plastic sleeve, pull out the tube.

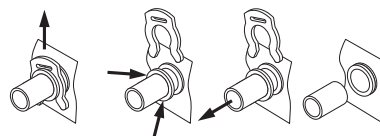

CONNECTING THE PRESSURE BOOSTING UNIT TO AQUAPHOR MORION RO-101S AND RO-101 DRINKING WATER MACHINES (FIG. 1)

- Turn off the water supply to the water purifier (close the tap of the connection node).
- Relieve the pressure in the RO according to the manual for your RO.
- Remove the RO cover.
- Remove the plug from the fitting (11).
- Disconnect the tube included in the RO kit from the connections (2) and (6).
- Disconnect the tube (9) from the fitting (8).
- Connect the assembled Pressure reducer with a pipe (1), supplied with the Pressure boosting unit, to the nozzle (2). Then connect white tube JG (in) (3A) to the free outlet of the reducer (1) after passing it through the process hole (4) in the console. **Note that the tube should pass without sharp bends and kinks!**
- Connect white tube JG (out) (3B) to the fitting (6) after passing it through the process hole (4) in the console. **Note that the tube should pass without sharp bends and kinks!**
- Connect the assembled tee with the tube (7), which is included in the Pressure boosting unit kit, to the fitting (8). Then connect the JG tube (9), which is part of the RO circuit and exits the storage tank, to the tee (7).

- Connect one end of the blue JG tube (3C), included in the Pressure boosting unit kit, to the free outlet of the tee (7) after passing it through the process hole (10) in the console. Connect the second end of the tube to the fitting (11). **Note that the tube should pass without sharp bends and kinks!**
- Disconnect the membrane drainage tube and replace the restrictor with the one included in the Pressure boosting unit kit. Connect the membrane drainage tube.
- Put the RO cover back on.

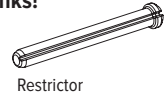

CONNECTING THE PRESSURE BOOSTING UNIT TO AQUAPHOR MORION RO-70 DRINKING WATER MACHINES (FIG. 2)

- Turn off the water supply to the water purifier (close the tap of the connection node).
- Relieve the pressure in the RO according to the manual for your RO.
- Remove the RO cover.
- Remove the plug from the fitting (12).
- Disconnect the tube included in the RO kit from the connections (2) and (6).
- Disconnect the tube (9) from the fitting (8).
- Connect the assembled Pressure reducer with a pipe (1), supplied with the Pressure boosting unit, to the nozzle (2). Then connect white tube JG (in) (3A) to the free outlet of the reducer (1) after passing it through the process hole (4) in the console. **Note that the tube should pass without sharp bends and kinks!**
- Connect white tube JG (out) (3B) to the fitting (6) after passing it through the process hole (4) in the console. **Note that the tube should pass without sharp bends and kinks!**
- Connect the assembled tee with the tube (7), which is included in the Pressure boosting unit kit, to the fitting (8). Then connect the JG tube (9) which is part of the RO circuit and exits the check valve, to the tee (7).
- Connect one end of the blue JG tube (3C), included in the Pressure boosting unit kit, to the free outlet of the tee (7) after passing it through the process hole (11) in the console. Connect the second end of the tube to the fitting (12). **Note that the tube should pass without sharp bends and kinks!**
- Disconnect the membrane drainage tube and replace the restrictor with the one included in the Pressure boosting unit kit. Connect the membrane drainage tube.
- Put the RO cover back on.

COMMISSIONING

- Connect the power supply to the Pressure boosting unit
- Plug the power supply into an outlet
- Turn on the water supply to the water purifier (open the tap of the connection node). After passing the Pressure boosting unit and water purifying system, water will begin to flow into the storage tank (or jug). The Pressure boosting unit will switch off when the storage tank (or jug) is full.

OPERATION

The Pressure boosting unit is fully assembled, tested and ready for operation.

ATTENTION! The Pressure boosting unit is adjusted and does not require further adjustments.

The manufacturer is not responsible for changing the Pressure boosting unit settings.

ATTENTION! The service life of the Pressure boosting unit directly depends on the operability of the water purifier cartridges, it is very important to replace the filtering cartridges in time.

ATTENTION! To increase the service life of the Pressure boosting unit in Aquaphor Morion RO-101, RO-70 use pre-treatment systems (purchased separately) to reduce the risk of mechanical debris from the main water supply.

During the first week of operation, check the Pressure boosting unit daily for leaks.

Do not allow the Pressure boosting unit to work at a pressure in the water supply greater than 0.63 MPa (6.5 at).

The operating temperature is from +5 to +38 °C.

If the characteristics of the source water significantly exceed the requirements of national standards for drinking water, we recommend that you install additional water treatment systems (mechanical cleaning systems, etc.).

Use a water purifier with the Pressure boosting unit only for cleaning water from the cold water supply system.

Disposal in accordance with environmental, sanitary and other requirements established by national standards in the field of environmental protection and ensuring the sanitary and epidemiological well-being of the population.

MANUFACTURER WARRANTY

Service life of the Pressure boosting unit is 5 years* from manufacturing date.** The Pressure boosting unit shall be replaced upon expiration of the service life.***

Shelf life of the Pressure boosting unit before operation is maximum 3 years at temperature from +5 to +38 °C, without removing packaging.

Warranty period**** of the Pressure boosting unit is 1 year from the purchase date. The purchase date of the Pressure boosting unit is the date of the retailers stamp in this manual or the date of the sales receipt. The manufacturer shall bear no warranty if this manual containing date of sale is lost and there are no other ways to determine the period of the product operation.

Please contact the retailer or the manufacturer in case of any claims to operation of the Pressure boosting unit.

The manufacturer shall bear no responsibility in any of the following cases:

- the consumer does not follow installation instructions described in this manual for the Pressure boosting unit and connecting it to the water purifier of the certain model;
- the consumer does not follow water purifier installation instructions described in the manual for a water purifier used with the Pressure boosting unit;
- the Pressure boosting unit is connected and used with water purifiers other than those specified in this manual;
- the Pressure boosting unit is used beyond the limits set by the technical specifications in this manual.

TROUBLESHOOTING

Fault	Problem	Solution
The pump does not turn on	Insufficient water pressure in the main water supply	Contact the plumbing service
	Not detected	Contact customer service
The pump does not turn off	The drinking water tap is open	Close the drinking water tap
	Not detected	Contact customer service
Water tank not filling quick enough	Water purifier cartridges are clogged	Replace water purifier cartridges
	Not detected	Contact customer service

In case of any other faults contact the customer service!

* Regardless of the operation starting date.

** Manufacturing date is the date in the format DD.MM.YYYY shown by the manufacturer on the label placed on the housing.

*** Using the Pressure boosting unit beyond its service life may result in harm to the health or property of the consumer or other persons and must be discontinued.

**** The period during which the manufacturer must satisfy the customer's claims in case of faults in the product.

Figure 1. Connection diagram of the Pressure boosting unit to the Aquaphor Morion RO-101S and RO-101 drinking water machines

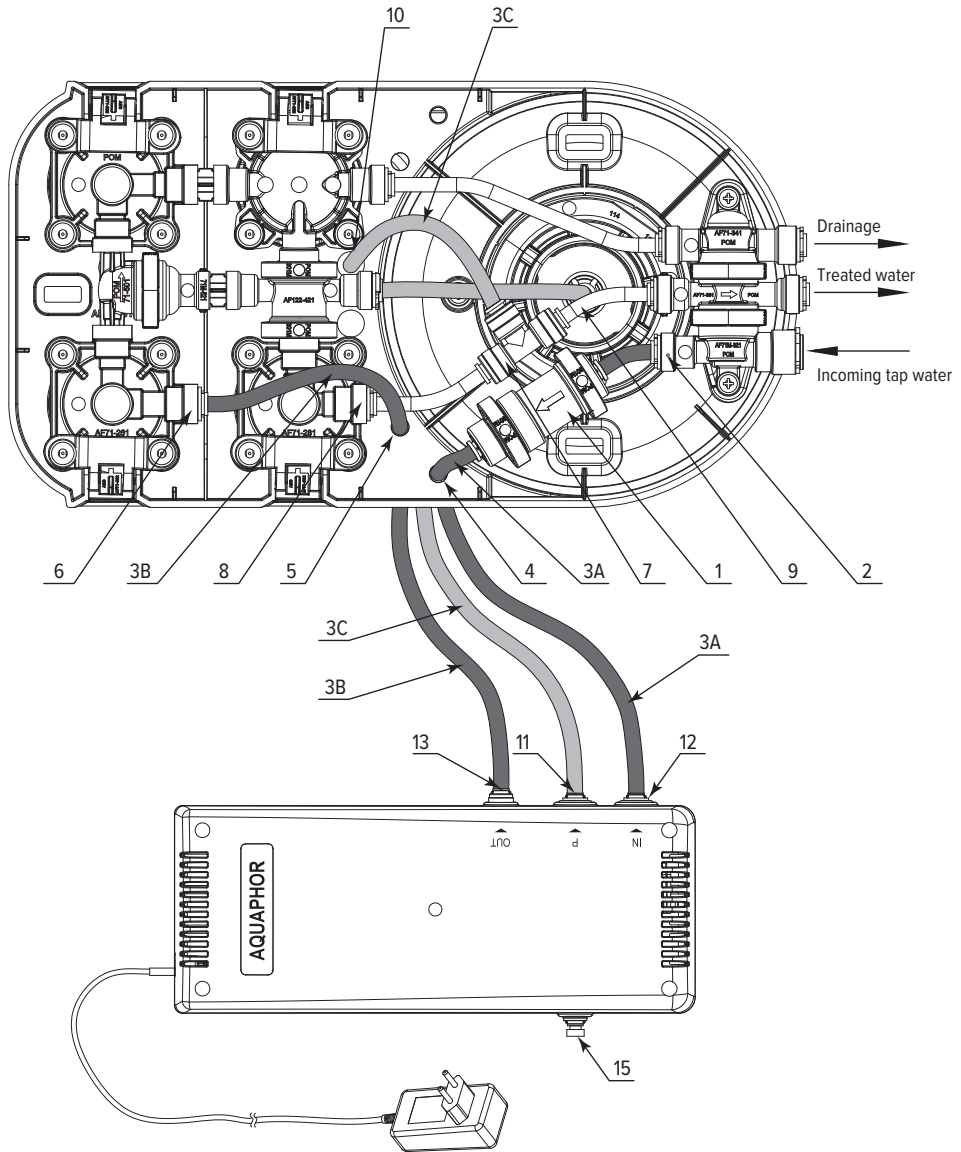
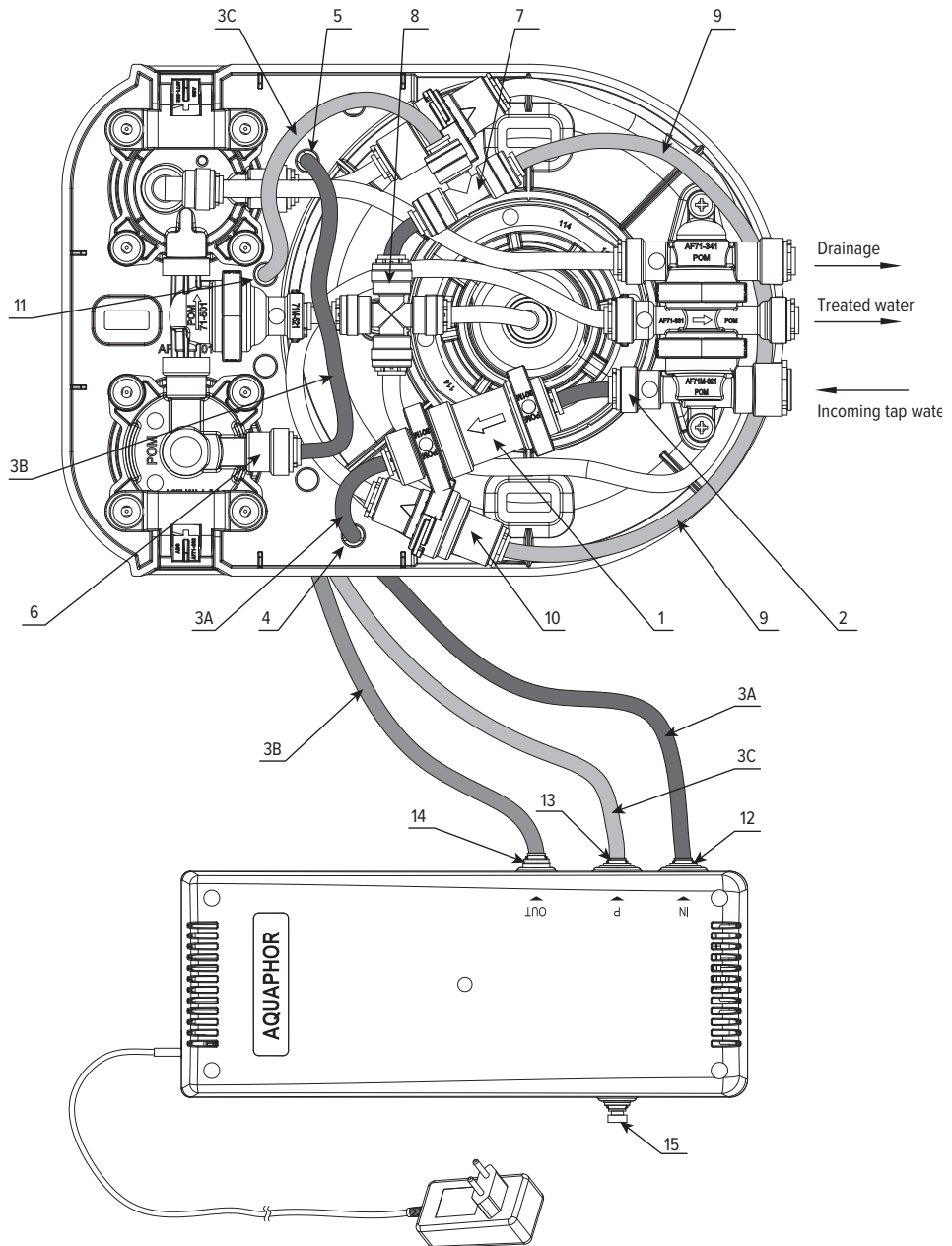

Figure 2. Connection diagram of the Pressure boosting unit to the Aquaphor Morion RO-70S and RO-70 drinking water machines



PRESSURE BOOSTING UNIT (100 GPD)

Manufacturer: Aquaphor International OÜ, L. Tolstoi 2A,
Sillamäe, Estonia, 40231.

The manufacturer reserves the right to make improvements
to the design of the Pressure boosting unit without reflecting
them in the passport.

Date of manufacture and quality control